



轴承型号 RQJT719/ISC

外形尺寸(mm)

d: 1

D: 4

B: 1.6

极限转速(rpm)

脂润滑: -

油润滑: -

额定载荷

Cr(N): -

Cr(N): -

重量(kg) 0.0001

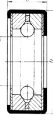

30273MMX17 30268A/17 30264A/17

双列深沟球轴承

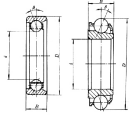

6206 6205 6204 6203 6202 6201

无内圈、无外圈的单列角接触球轴承

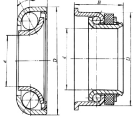

71906 71905 71904 71903 71902 71901

单列深沟球轴承

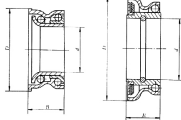

20701 20702 20703 20704 20705 20706



30406 30405 30404 30403 30402 30401

双列深沟球轴承

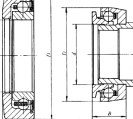

71906 71905 71904 71903 71902 71901

单列深沟球轴承

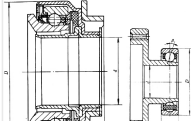

6206 6205 6204 6203 6202 6201

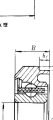

30406 30405 30404 30403 30402 30401

双列深沟球轴承

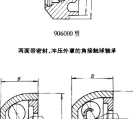

6206 6205 6204 6203 6202 6201

无内圈、无外圈的单列角接触球轴承

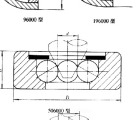

6206 6205 6204 6203 6202 6201

深沟球轴承

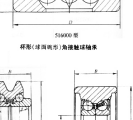

6206 6205 6204 6203 6202 6201

深沟球轴承

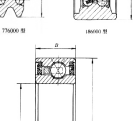

6206 6205 6204 6203 6202 6201

深沟球轴承



6206 6205 6204 6203 6202 6201

深沟球轴承